

High Corrosion Resistance Stainless Steel Chain Link D Shackles

Product Features

Manufactured from Stainless Steel EN10088 1.4404 (Marine Grade 316L)
 Excellent for lifting applications where a high level of corrosion resistance is required
 Factor of Safety 6:1
 Unique design enabling the shackle to be made captive to a chain sling without the need for welding
 The special Brace pin allows the shackle to be permanently attached to the chain on-site. This results in the shackle becoming part of the chain assembly
 The extended load pin is fitted with a split pin to ensure that the load pin remains in position even under vibration
 All shackles CE marked and supplied with instruction leaflet on safe use and storage

Quality Features

Every shackle is proof tested to 2 x WLL and certified at our manufacturing facility in the North East of England
 All shackles are manufactured in accordance with the Machine Directive 2006/42/EC
 Inspection certificate BS EN 10204 3.1b available on request
 High quality finish and excellent polish
 Manufactured using the latest technology in electrical upset forging

Typical Applications

Water utility installations & other corrosive facilities
 Pump chains and pump lifting

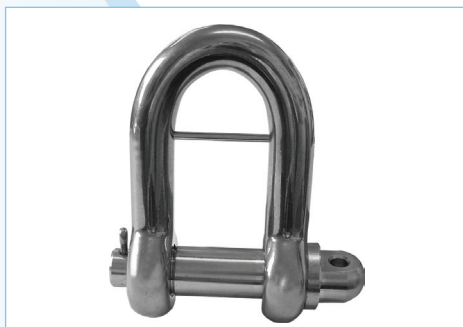
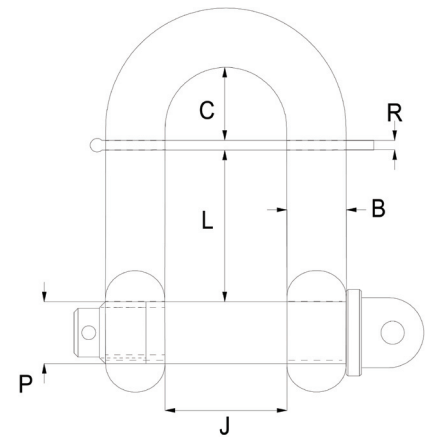

Chain Link Shackle

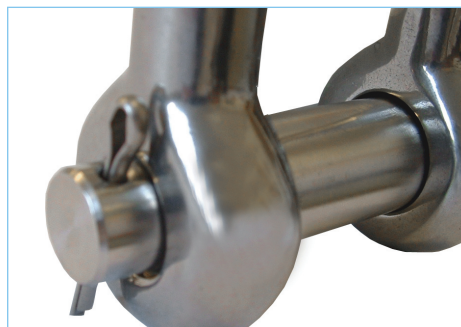

Safety pin



Brace pin

DIMENSIONS & WLL							PRODUCT NUMBER	NOMINAL WEIGHT Per Shackle
WLL (t)	Pin Dia (P)	Boday Dia (B)	Jaw Gap (J)	Inside L	R	C		
1	12.5	9.5	20.0	25.0	2.0	15.0	CTS1T	150g
2	19.0	16.0	32.0	40.0	3.0	22.0	CTS2T	55g
3.2	22.0	19.0	38.0	45.0	4.0	28.0	CTS32T	1000g
5	25.0	22.0	44.0	55.0	4.0	29.0	CTS5T	1900g
6	28.0	25.0	51.0	65.0	4.0	34.0	CTS6T	2300g